

### General Description

A normally open high flow valve with forged brass body and seat, 304/430F stainless steel operator. Suitable for low head and zero head applications.

Available in various seat materials including Viton (standard), Silicone,

Neoprene & Nitrile. Liquids to 40cst viscosity. Standard coil is weatherproof to IP65 and has LED illuminated plug.

Typical Applications include: Hot water, petrochemical tank drain or low pressure service & general industry.



Model	Function	Port Size BSP	Orifice Ømm	CV	Pressure (BAR)		Vacuum Hg"	Media Temp	Weight Kg	Features	
					AC	DC					
<b>Direct Plunger Operation – Normally Open</b>											
B56-2-3	N.O	1/4	3	0.26	0-10	0-10	NA	-10°C   100°C	0.50	Body- Brass Seals- Viton (Std) Silicone Teflon Operator- Stainless Steel	Air & Fluid
B56-2-4		1/4	4	0.58	0-6	0-6			0.50		
B56-2-5		1/4	5	0.64	0-4	0-4			0.50		
B56-3-4		3/8	4	0.58	0-6	0-6			0.80		
B56-3-6		3/8	6	0.79	0-2	0-2			0.80		
B56-4-6	N.O	1/2	6	0.79	0-2	0-2	0.95	0.95			
<b>Servo Assisted Diaphragm Valve – Normally Open</b>											
B56-3-15	N.O	3/8	15	4.5	.5-10	.5-10	NA	-10°C   100°C	1.4	Body-Brass Seals- Viton (Std) Silicone Neoprene Operator- Stainless Steel	Air & Fluid  Also available in normally closed.
B56-4-15		1/2	15	4.5	.5-10	.5-10			1.4		
B56-5-20		3/4	20	9.3	.5-10	.5-10			1.8		
B56-6-25		1	25	13.2	.5-10	.5-10			1.9		
B56-7-35		1 1/4	35	26	.5-10	.5-10			3.0		
B56-8-35		1 1/2	35	26	.5-10	.5-10			3.0		
B56-9-50		2	50	48	.5-7	.5-7			5.1		
B56-6F-25		Flange	25	13.2	.5-10	.5-10			4.8		
B56-7F-35			35	26	.5-10	.5-10			7.0		
B56-8F-35			35	26	.5-10	.5-10			7.0		
B56-9F-50	N.O	Flange	50	48	.5-7	.5-7	10.5	10.5			

### IMPORTANT – Chemical Resistance

For specific information on chemical resistance of valve components to various Liquids and Gases, refer to the manufacturer or your distributor. See over page for applications warning. It is the responsibility of the user to determine suitability of the liner and body material to the application.

B5    6    -    4    -    15    -    1       V    □

Series B5

Function  
6 - normally open

Orifice

Code	Ports Size BSP	Code	Voltage
1	1/8	1	240v/50Hz
2	1/4	2	110v/50Hz
3	3/8	5	24v/50Hz
4	1/2	7	12vDC
5	3/4	8	24vDC
6	1	9	48vDC
7	1 1/4	11	415v/50Hz
8	1 1/2		
9	2		

Optional Extras

- F Flying Leads
- R Silver shading Ring
- Exd Dust & Ignition Proof, Flame Proof

Seat & Diaphragm

- V Viton
- S Silicone
- NE Neoprene
- N Nitrile
- T Teflon

2
1

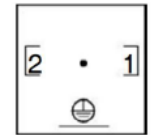

Earth Terminal  
Connector Plug with LED  
1 & 2 Input Terminals  
(Non polarity Conscious)

Coil Specifications

Model DIN	Power AC (VA)		DC (Watt)	Insulation Grade
	50Hz	60Hz		
Direct Plunger	24.2	19.8	18	H
Servo Assisted	15.4	11.7	12	H

**HIGH FLOW / DIRECT ACTING & SERVO ASSISTED / BRASS BODY SOLENOID VALVE – NORMALLY OPEN**

**SERIES B56**

**Valve Materials**

Item	Article	Material
1	Solenoid Tube	Stainless Steel
2	Slide Core	Stainless Steel
3	Coil	Brass Wire
4	Armature Core	Stainless Steel
5	Operating Spindle	Stainless Steel
6	Joint Sleeve	Stainless Steel
7	Spring	Stainless Steel
8	Seat	NBR, Silicone, Viton
9	Valve Body	Brass

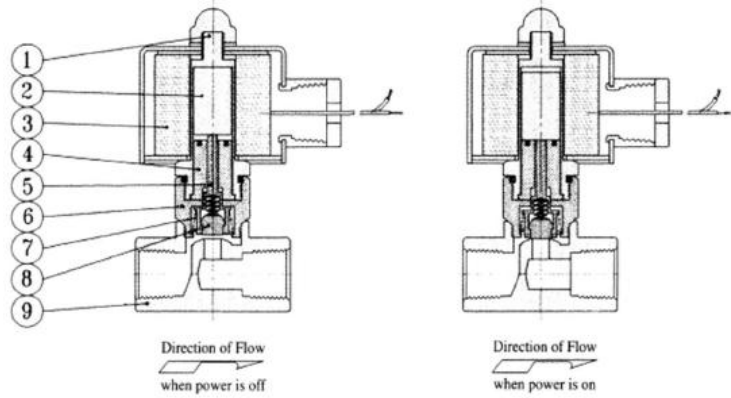

**Dimensions**

Model	A	B	C	F	G <sub>BSP</sub>	H	J
B56-2-3~5	41	19	108	-	¼	10.5	15
B56-3-4~6	50	25	110	-	3/8	11.7	15
B56-4-6	55	27	112	-	½	13	
B56-4-15	75	75	129	14.5	½		
B56-5-20	85	85	140	18	¾		
B56-6-25	100	100	146	23	1		
B56-8-35	120	120	166	33	1 ½		
B56-9-50	150	150	186	40.5	2		
B56-6F	140	125	162	14	1		
B56-8F	165	140	177	16	1 1/2		
B56-9F	200	155	195	16	2		

**Servo Assisted**

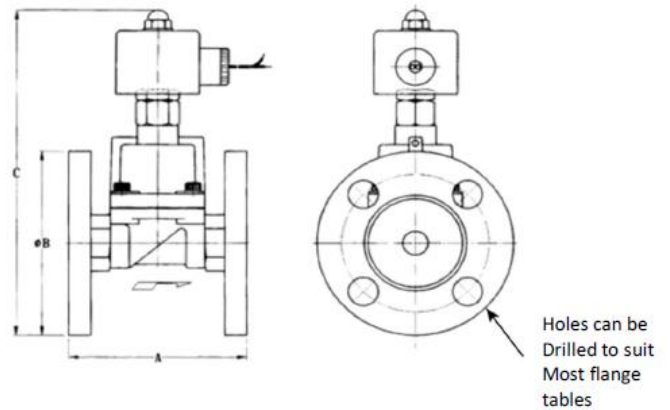

**Direct Plunger**

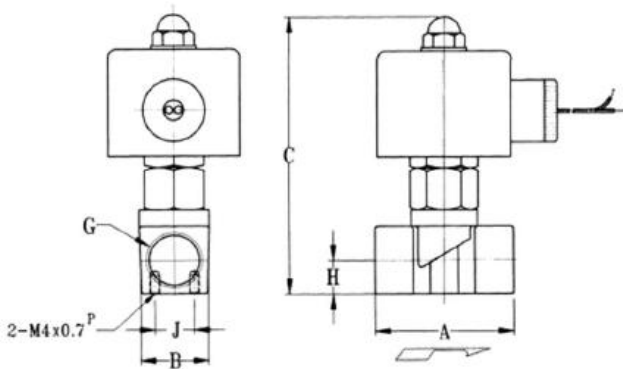

**Servo Assisted**

